



2016-2017 WINTER PARKING PERMIT APPLICATION PARKING AREA REVIEW

Property Address: _____ Date: _____

Name: (Property Owner or Authorized Representative): _____
(Property Owner's Signature Required Below)

Phone Number: _____ Email Address: _____

Number of Living Units: _____ Is the Property Grandfathered (if applicable): **Y** or **N**

Current Number of Parking Stalls on the Property: _____
(Parking stalls can be located in the garage, driveway, side-yard and rear-yard only, NO parking is allowed in the front yard or the park-strip areas)

Requested Number of Permits: _____ Additional Comments/Info: _____

(Use diagram below or backside if needed)

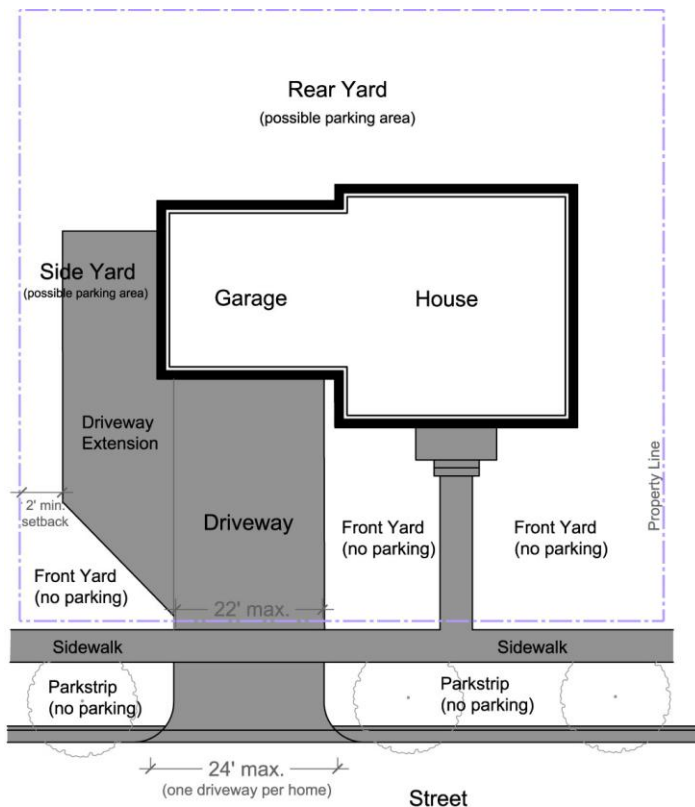

Winter Parking Restriction

10.52.170 (A) of the Municipal Code states: No person shall park a vehicle on any street or city owned parking lot between the hours of midnight (12:00) A.M. and six o'clock (6:00) A.M. of any day, beginning November 15 and ending March 15 of each year. Winter Parking Permits may be purchased by property owners of legally existing non-conforming residential properties built prior to 1968 if said properties cannot physically accommodate legal on-site parking. Permits shall be purchased and renewed annually and shall be limited to a maximum of two permits per legally existing unit. The actual number of permits per unit will be determined by considering, the number of existing off-street stalls and any physical space available for additional off-street parking stalls. Permit fees shall be set by council resolution. Other permit conditions may be required administratively if deemed necessary to minimize negative impacts.

FOR STAFF USE ONLY

Grandfathering Verification Y / N
 Aerial Photo Property Review Y / N
 Year Built _____
 Number of Permits Justified _____
 Initial / Date _____

Winter Parking Permit Application

 (Initial) Applicant acknowledges that Parking Permit(s) issued are non-refundable

Property Owner's Signature: _____
(The property owner must sign this form to authorize any representative on her/his behalf)